

## USE EXTERNAL SPEAKER

In situations where a higher volume level is required, you can use the an optional external speaker (SP-30/SP-35).

### NOTE:

- Turn OFF the transceiver and speakerphone before connecting the speaker.
- The internal speaker is muted while an external speaker is connected.

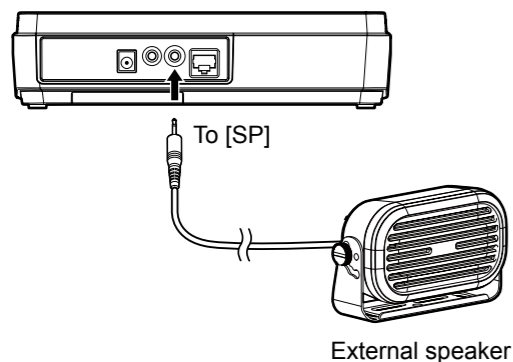

External speaker

## SPECIFICATION

Input voltage:	12 ~ 16 V DC or the specified Icom power adapter (BC-242)
Operating temperature range:	-10°C ~ +60°C, 14°F ~ 140°F (When using the power adapter: 10°C ~ 40°C, 50°F ~ 104°F)
Current drain:	Less than 1.0 A
Stand-by power:	600 µA (When using alkaline batteries)
AF output power:	More than 1.1 W at 10% distortion with an 8 Ω load
Microphone output level:	5 mVrms ± 20% (Microphone input level: 10 mVrms (Measurement condition: 1 kHz))
Charging current:	700 mA ± 10% (rapid charging)
Dimensions (approximate):	216.8 (W) × 52.8 (H) × 173.3 (D) mm, 8.5 (W) × 2.1 (H) × 6.8 (D) inch (projections not included)
Weight (approximate):	595 g, 1 lb 5 oz (without the supplied accessories)

## FCC INFORMATION

This equipment has been tested and found to comply with the limits for a Class B digital device, pursuant to part 15 of the FCC Rules. These limits are designed to provide reasonable protection against harmful interference in a residential installation. This equipment generates, uses and can radiate radio frequency energy and, if not installed and used in accordance with the instructions, may cause harmful interference to radio communications. However, there is no guarantee that interference will not occur in a particular installation.

If this equipment does cause harmful interference to radio or television reception, which can be determined by turning the equipment off and on, the user is encouraged to try to correct the interference by one or more of the following measures:

- Reorient or relocate the receiving antenna.
- Increase the separation between the equipment and receiver.
- Connect the equipment into an outlet on a circuit different from that to which the receiver is connected.
- Consult the dealer or an experienced radio/TV technician for help.

**CAUTION:** Changes or modifications not expressly approved by the party responsible for compliance could void the user's authority to operate the equipment.

This device complies with Part 15 of the FCC Rules. Operation is subject to the following two conditions: (1) this device may not cause harmful interference, and (2) this device must accept any interference received, including interference that may cause undesired operation.

## ABOUT CE

**CE** Versions of the VE-SP1 which have the "CE" symbol on the product comply with the essential requirements of the 2014/30/EU directive for Electromagnetic Compatibility and the 2001/95/EC directive for General Product Safety.

Icom is not responsible for the destruction, damage to, or performance of any Icom or non-Icom equipment, if the malfunction is because of:

- Force majeure, including, but not limited to, fires, earthquakes, storms, floods, lightning, other natural disasters, disturbances, riots, war, or radioactive contamination.
- The use of Icom transceivers with any equipment that is not manufactured or approved by Icom.

Icom, Icom Inc. and the Icom logo are registered trademarks of Icom Incorporated (Japan) in Japan, the United States, the United Kingdom, Germany, France, Spain, Russia, Australia, New Zealand, and/or other countries.

# ICOM INSTRUCTIONS

## SPEAKERPHONE UNIT

### VE-SP1

Thank you for choosing this Icom product.  
**READ ALL INSTRUCTIONS** carefully and completely before using this product.

## EXPLICIT DEFINITIONS

WORD	DEFINITION
<b>⚠ DANGER!</b>	Personal death, serious injury or an explosion may occur.
<b>⚠ WARNING!</b>	Personal injury, fire hazard or electric shock may occur.
<b>CAUTION</b>	Equipment damage may occur.
<b>NOTE</b>	Recommended for optimum use. No risk of personal injury, fire or electric shock.

## DISPOSAL



The crossed-out wheeled-bin symbol on your product, literature, or packaging reminds you that in the European Union, all electrical and electronic products, batteries, and accumulators (rechargeable batteries) must be taken to designated collection locations at the end of their working life. Do not dispose of these products as unsorted municipal waste. Dispose of them according to the laws in your area.

## PRECAUTIONS

**⚠ DANGER! NEVER** charge or use a third-party or counterfeit battery pack or power adapter. Otherwise, a fire and/or explosion may occur. Charge only the BP-271 and BP-272 battery packs. Only tested and approved for use with the BP-271 and BP-272.

**⚠ DANGER! KEEP** battery packs away from fire. Fire or heat may cause them to rupture or explode. Dispose of an used battery pack in accordance with local regulations.

**⚠ WARNING! NEVER** charge the battery packs during a lightning storm. It may result in an electric shock, cause a fire or damage the battery pack or transceiver. Always disconnect the power adapter before a storm.

**⚠ WARNING! NEVER** modify the speakerphone and/ or power adapter. This may cause a fire hazard or electric shock.

**⚠ WARNING! NEVER** use deteriorated battery packs. They could cause a fire.

**CAUTION: DO NOT** charge the battery packs in areas with extremely high temperatures, such as near fires or stoves, inside a sun heated vehicle, or in direct sunlight. In such environments, the safety/protection circuit in the battery will activate, causing the battery to stop charging.

**CAUTION: DO NOT** insert the battery packs (with/without the transceiver) into the speakerphone if it is wet or soiled. This could corrode the speakerphone terminals or damage the speakerphone. The speakerphone is not waterproof.

**CAUTION: DO NOT** let metal, wire, and so on, touch any internal parts of the speakerphone.

**CAUTION: DO NOT** charge the battery in conditions of extreme cold (under 10°C, 50°F), or extreme heat (over 40°C, 104°F).

The battery may heat up or rupture if charged out of the specified temperature range. Additionally, battery performance or battery life may be reduced.

**CAUTION: DO NOT** use the speakerphone with the power adapter when it is covered by objects that impede heat dispersal.

**CAUTION:** Occasionally observe the battery pack condition while charging. If any abnormal condition occurs, discontinue using the battery pack.

**USE INDOORS ONLY! NEVER** expose the speakerphone and the power adapter to rain, snow or any liquids.

Always place the speakerphone in a secure place to avoid inadvertent use by unauthorized person.

**USE** only specified accessories. Using third party or counterfeit may result in a fire hazard or electric shock.

**KEEP** the speakerphone away from TV sets or radios to prevent interference.

**MAKE SURE** battery and speakerphone contacts are always clean. Otherwise, battery packs may not be charged properly.

Be careful of the battery pack's temperature—when the battery pack is extremely cold, the speakerphone cannot charge the pack.

When the speakerphone is not in use, disconnect the power adapter from an AC outlet. The power adapter consumes power when connected to the AC outlet.

When the operating period becomes extremely short after full charging, the battery pack has reached the end of its life and a new battery pack must be purchased.

**NOTE:** If your battery packs seem to have no capacity even after being fully charged, completely discharge them, then fully charge them again. If they still do not retain a charge (or very little), a new battery packs must be purchased.

## FEATURES

### • Teleconference Call System with the Icom IP Transceiver

- ① The VE-SP1 is the option for the Icom IP transceiver. For compatible models, see the Icom website.
- ① The IP501H and IP503H are usable, as of May, 2019. For IP transceiver operation, see the IP transceiver manual posted on the Icom website.

- **External microphone (supplied) and external speaker (option) are available**
- **Battery pack can be charged when the power adapter is connected**
- **You can use the VE-SP1 with AA (LR6) size alkaline batteries**

- ① The battery pack cannot be charged.

## UNIT DESCRIPTION

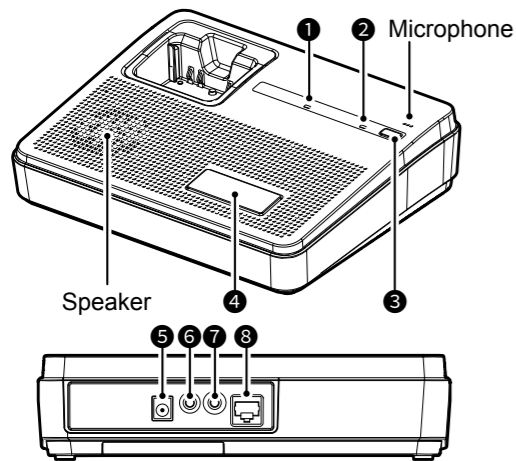

### ① CHARGER INDICATOR

Lights when the power adapter is connected, and the IP transceiver or the battery pack is inserted.

- Lights orange: Charging
- Lights green: Charged
- Blinks orange: A charging error has occurred. Reinsert the IP transceiver or the battery pack.

### ② ON/OFF INDICATOR [ON/OFF]

Lights when the speakerphone power is ON.

- ① [ON/OFF] does not light when you use with the transceiver battery. (The switch on the bottom is OFF.)

### ③ POWER SWITCH [POWER]

Push to turn the speakerphone ON or OFF.

- ① [ON/OFF] is disable when you use with the transceiver battery. (The switch on the bottom is OFF.)

### ④ PTT SWITCH [PTT]

Push to switch between transmitting and non-transmitting.

### ⑤ DC JACK [DC]

Connect the supplied power adapter.

### ⑥ MICROPHONE JACK [MIC]

Connect the supplied external microphone.

### ⑦ SPEAKER JACK [SP]

Connect the optional external speaker.

### ⑧ TRANSCEIVER PORT [TRX]

Connect the supplied connection cable.

## SUPPLIED ACCESSORIES

Item	Quantity
• Connection cable (OPC-2397).....	1
• External microphone (SM-1).....	1
• Power adapter (BC-242).....	1
① Alkaline batteries are not supplied.	

## CONNECTION

### ■ IP Transceiver

#### NOTE:

- You can use the VE-SP1 with the IP transceiver that the firmware is updated for the VE-SP1. Ask your dealer for details of the IP transceiver firmware.
- You can use the VE-SP1 when "Speakerphone Unit" is set to "Use" in the transceiver set mode.
- Turn OFF the transceiver and speakerphone before connecting.
- Use with the IP transceiver inserted in the VE-SP1.

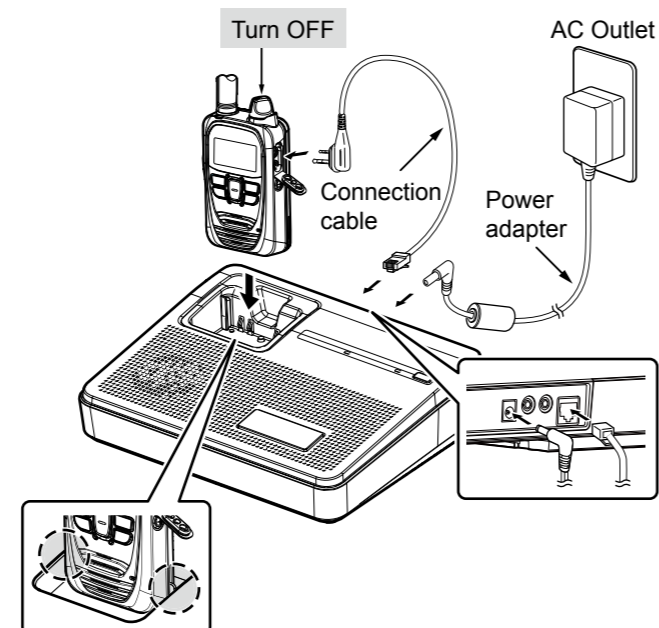

#### When connecting the connection cable

- Turn OFF the transceiver before connecting the cable.
- Connect or remove the cable by holding the plug not cable.
- Insert the plug securely when connecting the cable.
- Attach the jack cover when the connection cable is not connected.

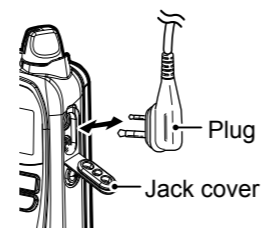

### ■ External microphone

You can use [PTT] on the external microphone that is connected to the speakerphone. Connect the microphone to the speakerphone, as shown below.

#### NOTE:

- Turn OFF the transceiver and speakerphone before connecting the microphone.
- Place the external microphone 1 m (3.3 ft) away from the speakerphone.

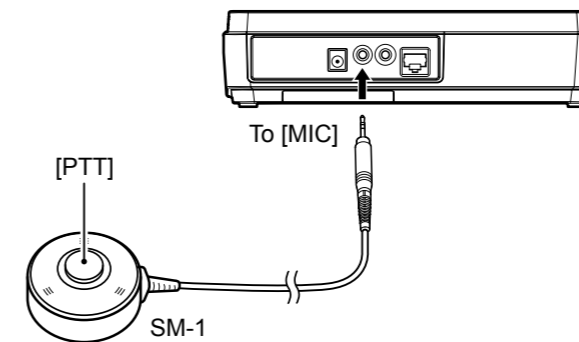

#### TIP:

- If feedback occurs, turn the transceiver's [PWR/VOL] counterclockwise to lower the volume level.
- If noise is heard in the transmitted voice, place the speakerphone and microphone in a quiet place.
- To prevent feedback, place the speakerphone and microphone in a place with little reverberation.
- Place the speakerphone and microphone on a flat desk.

## BASIC OPERATION

### 1. Turning ON the speakerphone

- Push [POWER] to turn ON the speakerphone.
- [ON/OFF] lights.

### 2. Turning ON the transceiver

- Turn the transceiver's [PWR/VOL] clockwise to the 12 o'clock position.
- A beep sounds.

### 3. Transmitting

- Push [PTT], and then speak into the microphone.
- The transceiver's [TX/RX] indicator lights red.
- ① Push [PTT] again to stop transmitting.

#### About the Time-out Timer:

When the continuous transmission period is set, the Time-out Timer automatically stops the transmission to prevent prolonged transmissions. Push [PTT], and then push [PTT] again to resume talking.

### 4. Receiving

- When a call is received, the transceiver's [TX/RX] indicator lights green.

### 5. Talk while receiving a call

- While receiving a call, push [PTT] to talk in the Full Duplex mode like a telephone call.
- In the Full Duplex mode, the transceiver's [TX/RX] indicator lights orange.

## USE DRY CELLS

The VE-SP1 can be operated with alkaline batteries. Remove the cover on the bottom, then set 8 AA (LR6) size alkaline batteries as shown below.

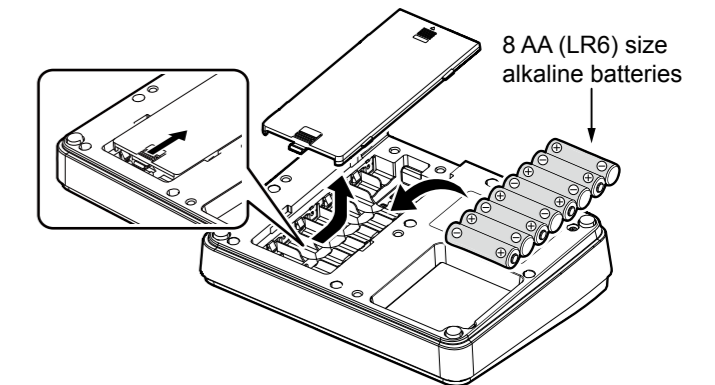

#### ① Information

- The battery life may differ, depending on the operating style, or the attached batteries.
- Batteries may seem to have low capacity when used in low temperatures.
- When the batteries are almost exhausted, the speakerphone is automatically turned OFF. Replace all batteries with new alkaline batteries.

**NOTE:** Remove the alkaline batteries when the VE-SP1 is not used.

## USE TRANSCEIVER BATTERY

When no standard power source is available, set the switch on the bottom to OFF to use the VE-SP1 with the transceiver battery.

**NOTE:** Turn OFF the transceiver and speakerphone before switching the switch.

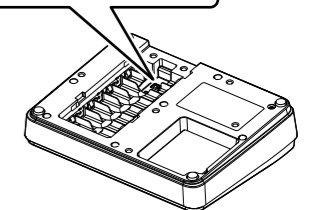
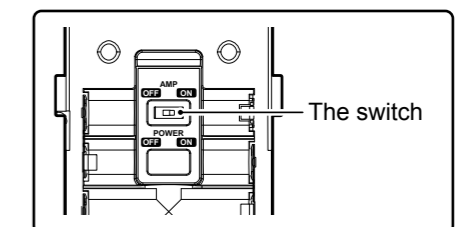

**ON:** Use the power adapter, or alkaline batteries. (Default)

**OFF:** Use the transceiver battery.

- ① [ON/OFF] does not light.

- ① The speaker volume level will be lower when OFF is set.